

PRODUCT SPECIFICATION

DESCRIPTION----120W LED Flood Light



LM79
LM80



● Features



- | | | | |
|--|--|--|---|
| <p>①</p> <p>Energy-saving</p> <p>Saving more than 80% power Energy than traditional lamps</p> | <p>②</p> <p>Eco-friendly</p> <p>No UV/IR, Safe solid Light source, No Mercury & lead.</p> | <p>③</p> <p>Easy to use</p> <p>Instant Start , No Flicker ,Free maintenance</p> | <p>④</p> <p>Long life-span</p> <p>More than 80,000 hours long lifespan. Low light failure.</p> |
|--|--|--|---|

● Technical Parameter

Model	GT-FL120W
Power	120W
Voltage	AC90-277V OR 347V
Working Frequency	50-60HZ
Power Efficiency	>95%
Luminous Flux	10,800LM
Power Factor	>0.90
Color Temperature	WW: 2700 - 3300K NW:4000 - 4500K CW: 5000 - 5500K
CRI	Ra >= 75
Bean Angle	130°
Working Temperature	-30 to +60 °C
IP Rate	IP65
Life-span	50,000hrs life, 5 Years Warranty

● Lux Parameter

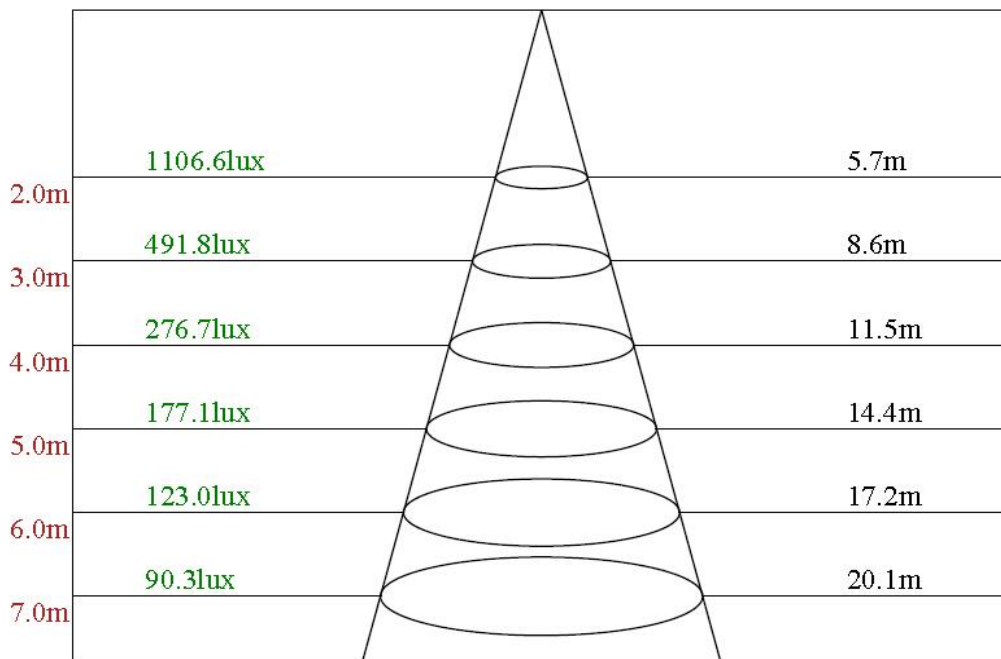

Beam angle of C180plane110.30

● Light Distribution Curve [Unit:cd]

Light Distribution Curve [Unit: cd]

Page : 4 Total:16

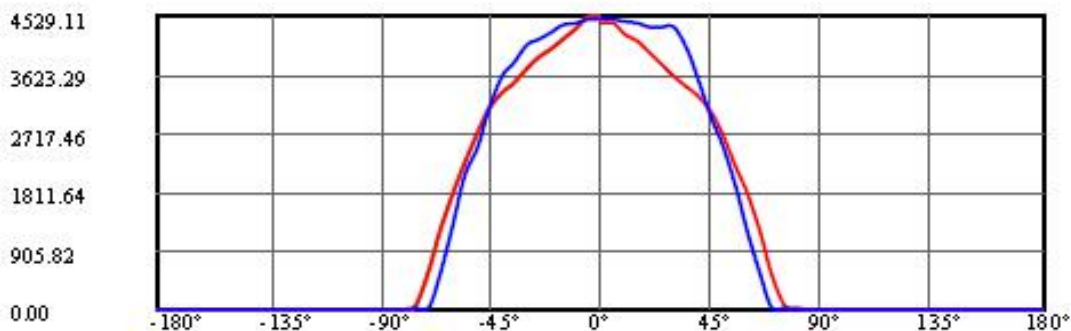
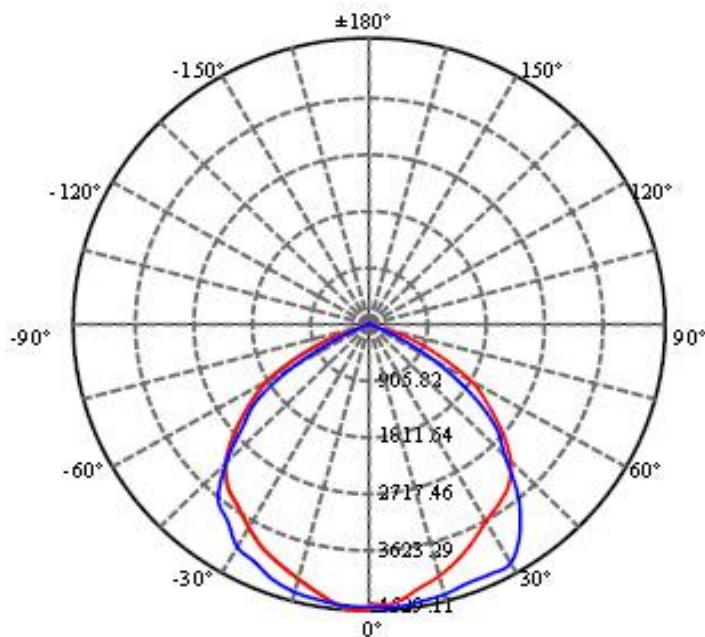

C180(Max): —
 C0/C180: —
 C90/C270: —

Field angle(10%Imax): C0/180Left:71.4 Right:71.0
 :C90/270Left:65.9 Right:65.8

Beam Angle(50%Imax): C0/180Left:55.4 Right:54.9
 :C90/270Left:53.1 Right:52.3

● Dimension

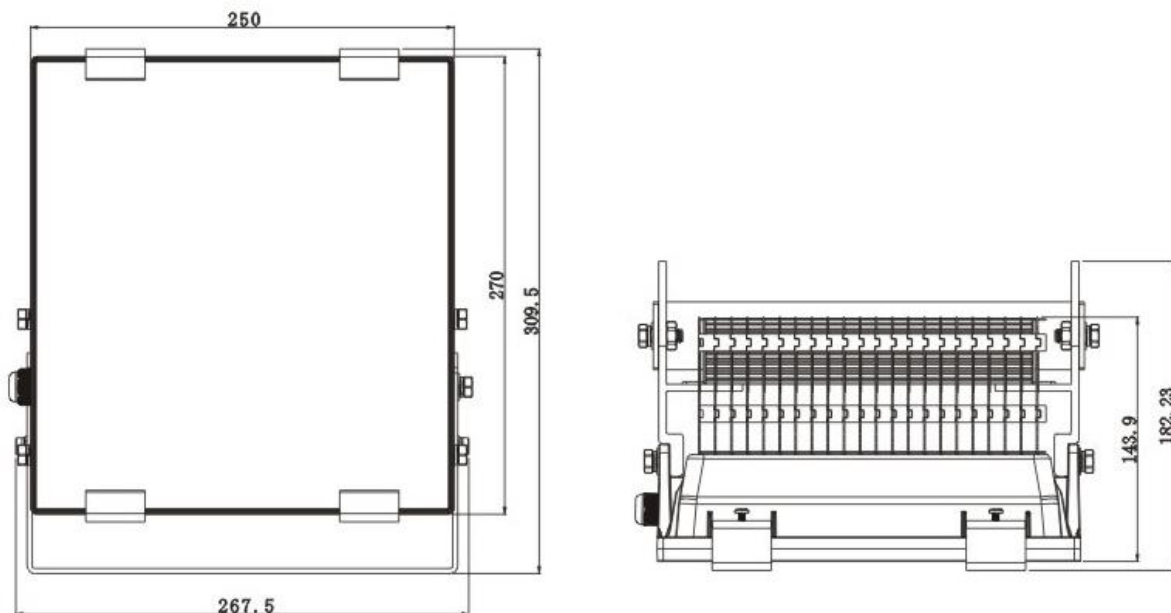

● Product Details

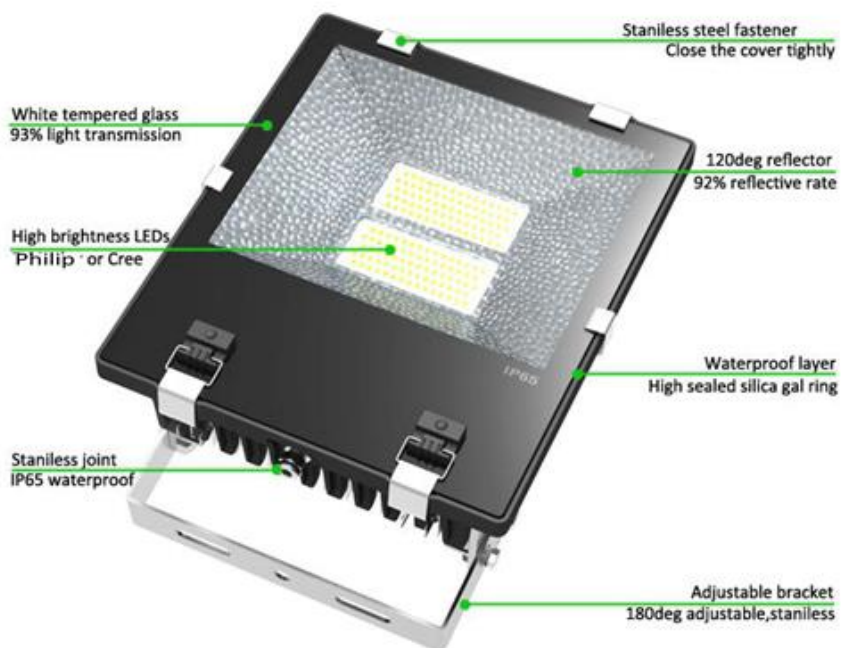

● Product Package

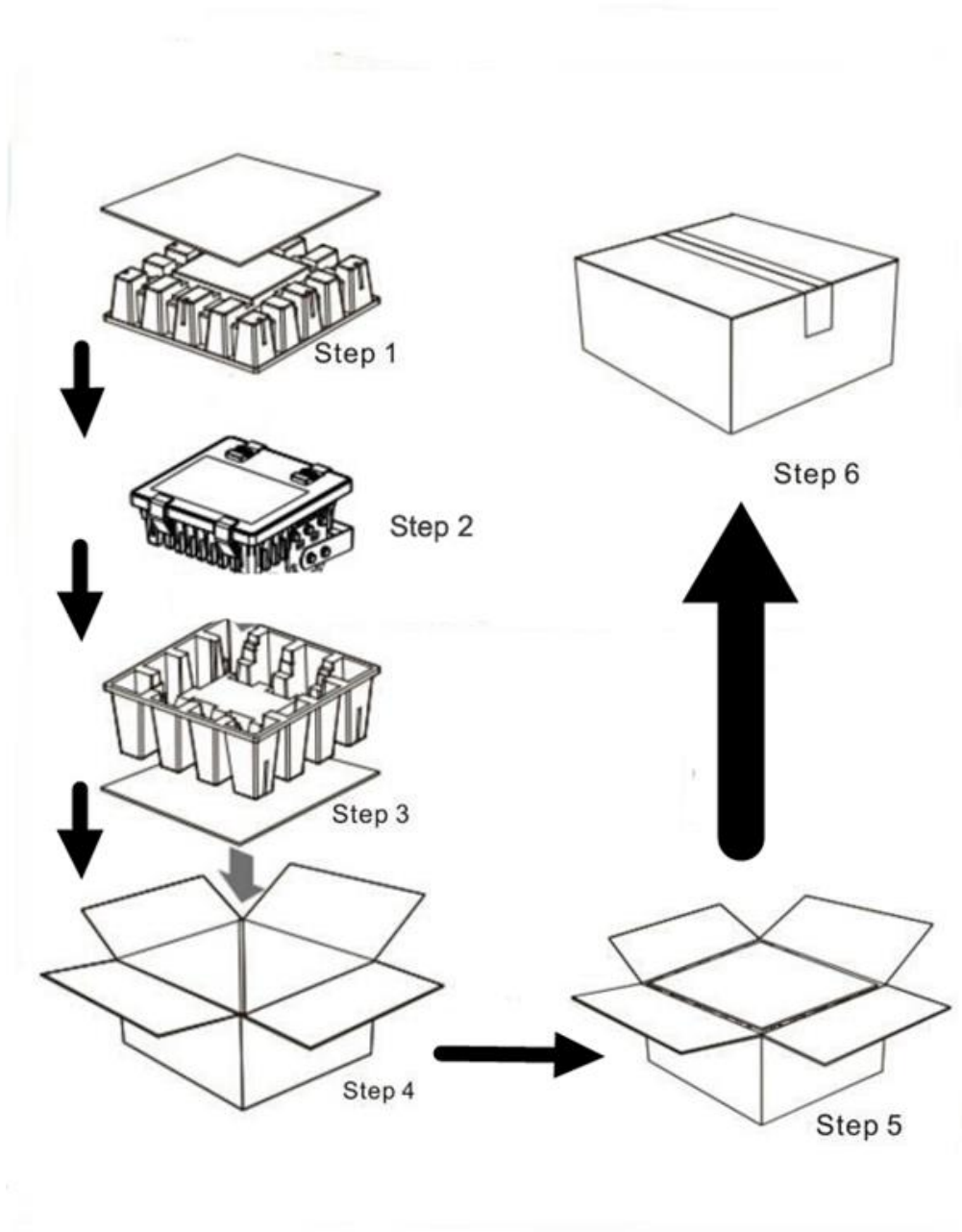

● Installation

- 1、 Before installation, please check the installation guide as Diagram1, Diagram 2 and Diagram 3 shows.
- 2、 Please fix the stands of the fixtures on the mounting holes and lock the stands by screws.
- 3、 Ensure the luminous direction is down. just like Diagram 4 shows.
- 4、 Connect (L: Black N: White GND: Green), According to the American connection standard.
- 5、 IP grade: IP65
- 6、 Switch on power
- 7、 Please see attached connection instruction

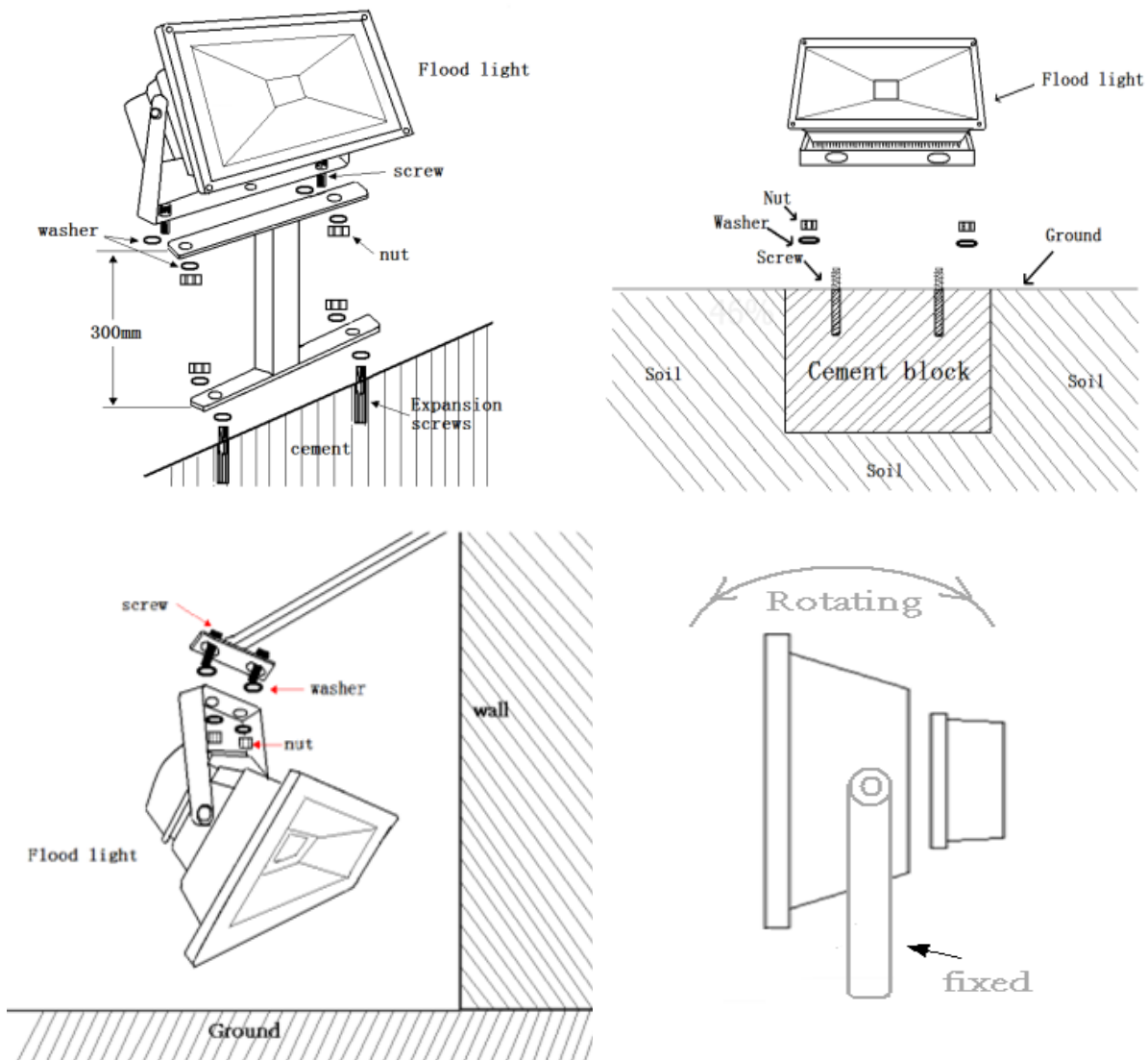

● Products Application Cases



The date mentioned in this file is for reference only, and the specific date should be subject to the specified products.

