

# MowGate

## User Manual

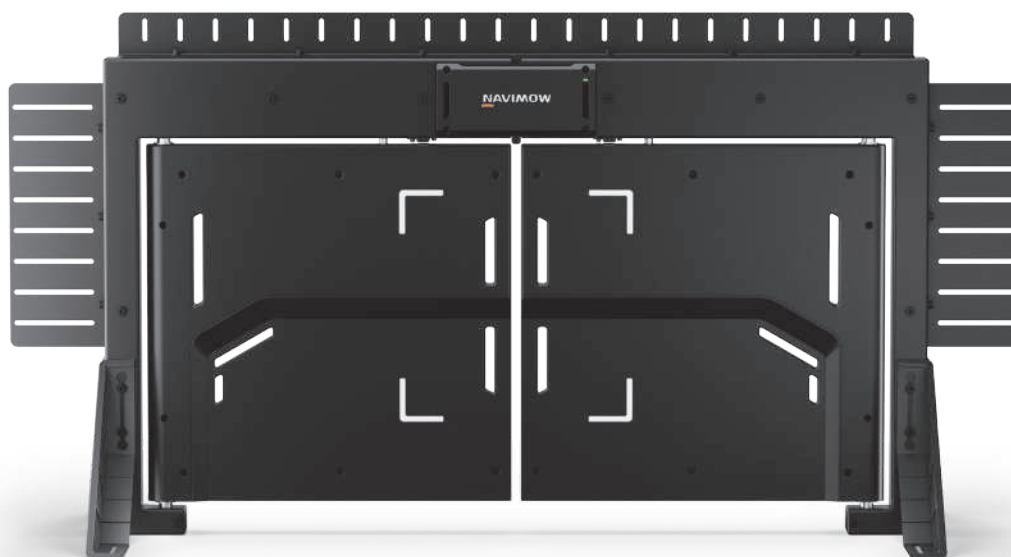

# Table of Contents

<b>1. Inside the box</b>	1
<b>2. Installation</b>	2
2.1 Find a spot	2
2.2 Cut an opening	2
2.3 Install the MowGate	3
2.4 Install batteries	4
2.5 Install the magnet	4
2.6 Create Channel to the MowGate	6
<b>3. Maintenance</b>	7
3.1 Replace batteries	7
3.2 Clean the MowGate	7
3.3 Lubricate the frames	7

# 1. Inside the Box

The MowGate is a smart accessory that is installed in an opening of a fence. When the mower approaches the MowGate, it automatically unlocks itself and locks again after the mower has passed through.

## MowGate

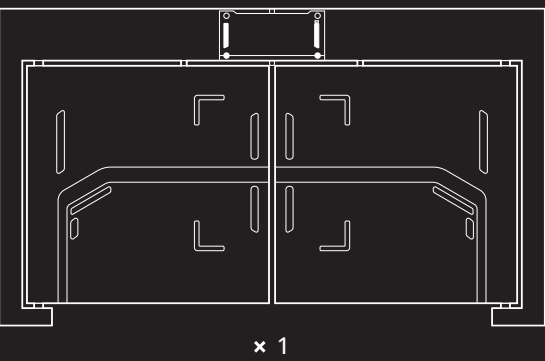

## Card board

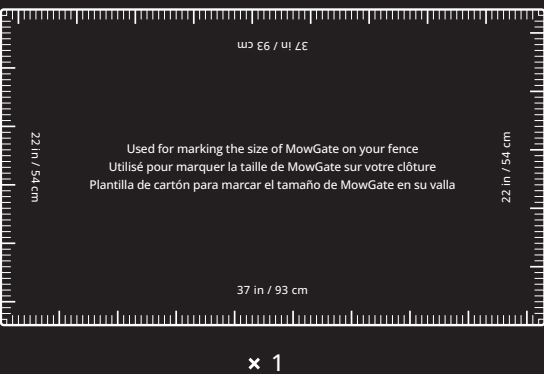

## Screws, bolts, and Allen key

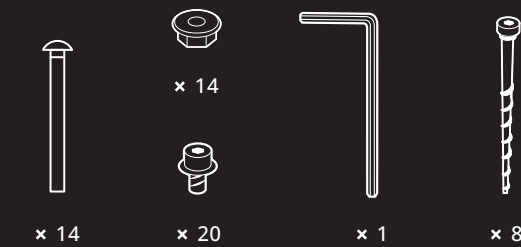

## Magnet and magnet holder



## Parts for supporting MowGate

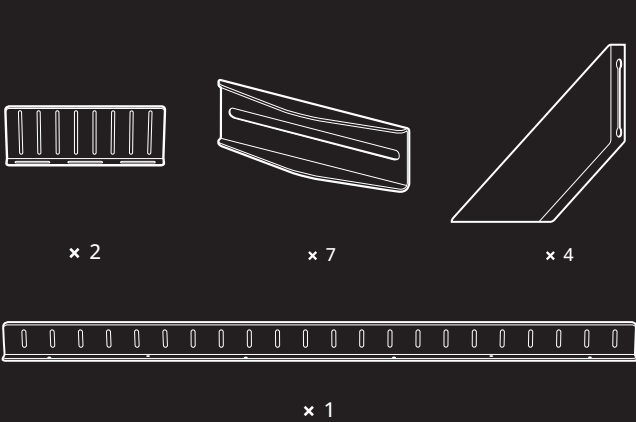

## 2. Installation

### Preparations

1. Wear protective gloves to avoid injuries
2. Prepare 4 batteries (Type D)

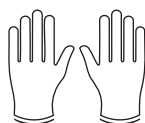

x 1



x 4

### 2.1 Find a spot

Install the MowGate on a flat surface, not on a slope.

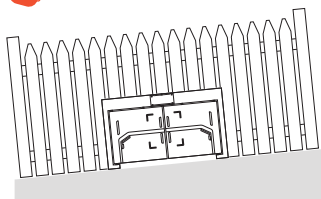
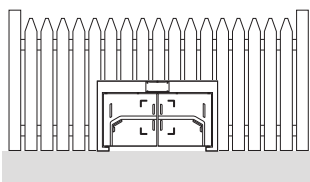
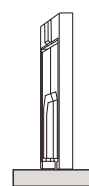
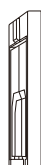

### 2.2 Cut an opening

Use the cardboard to mark the MowGate on your fence. Cut an opening on your fence. For mesh fences, use a reciprocating saw or an angle grinder.

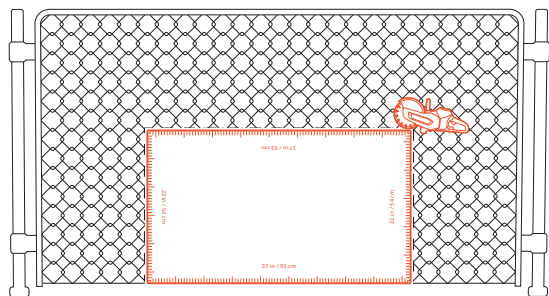

For fences with harder surface, use a reciprocating saw or an angle grinder and drill holes with an electric drill.

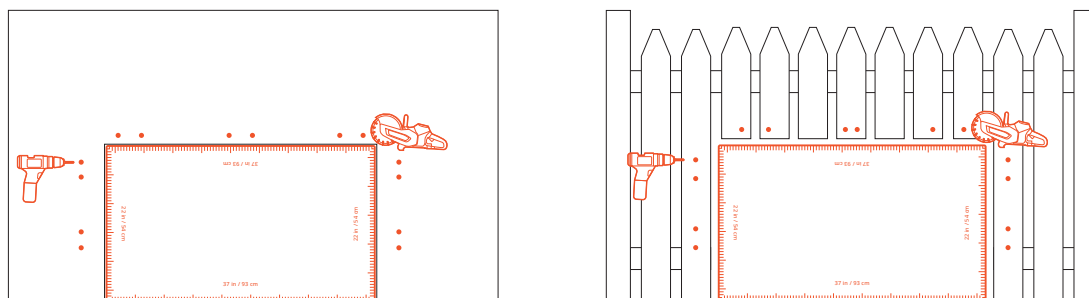

## 2.3 Install the MowGate

### For unstable structures

1. Install the frames on the top, left side, and right side of the MowGate.
2. For mesh fences, install the triangular supports on both sides.
3. Install the screws to attach the MowGate to your fence.

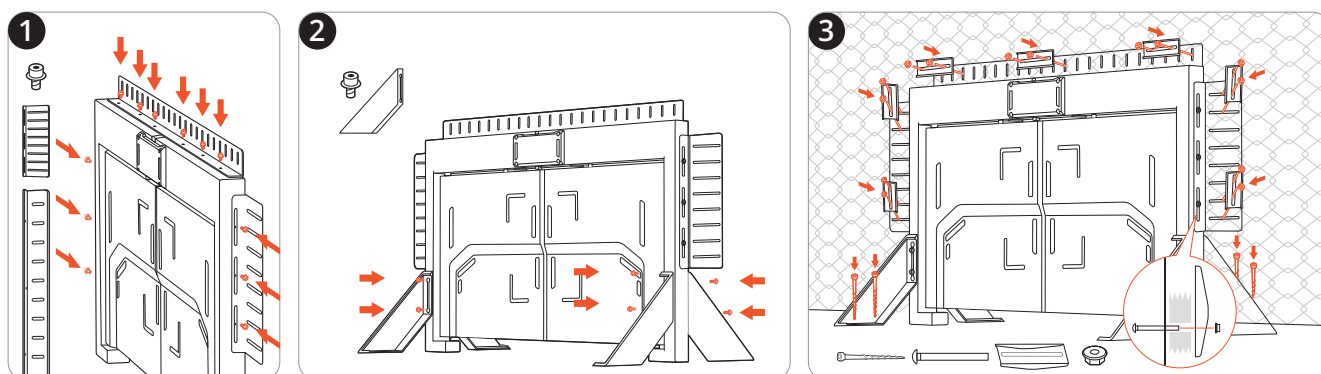

### For stable structures

1. Install the frames on the top, left side, and right side of the MowGate.
2. For wooden fences, align the drilled holes with the MowGate frames.
3. Install the screws to attach the MoGate to your fence.

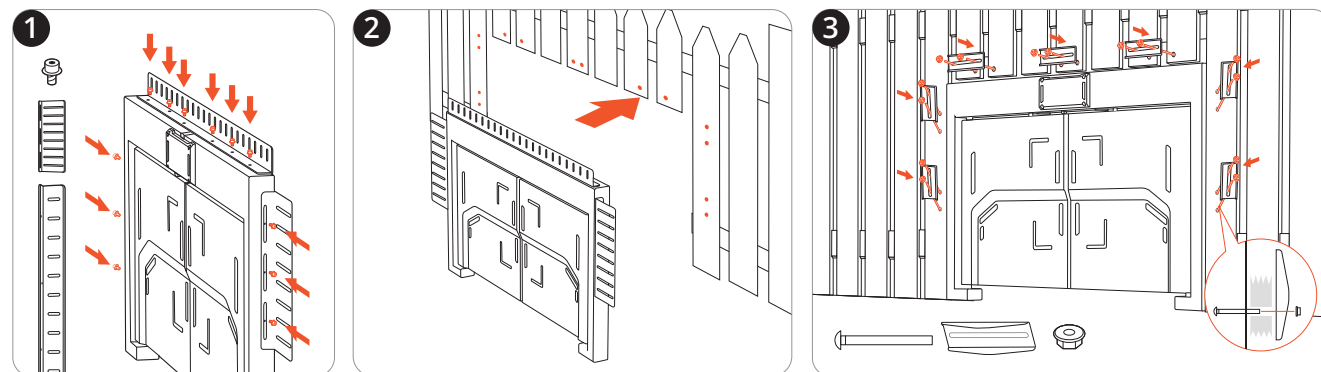

## 2.4 Install batteries

1. Remove the lid at the upper part of the MowGate.
2. Insert the 4 batteries (Type D).
3. Install the lid back onto the MowGate.
4. Wait until the light turns green.

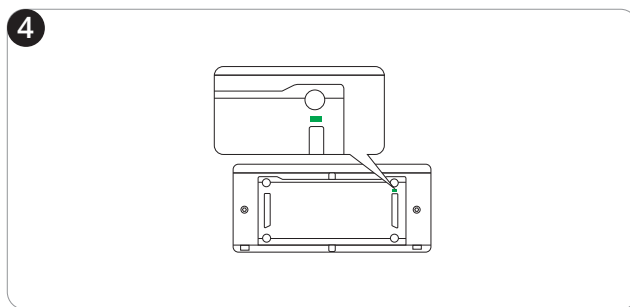
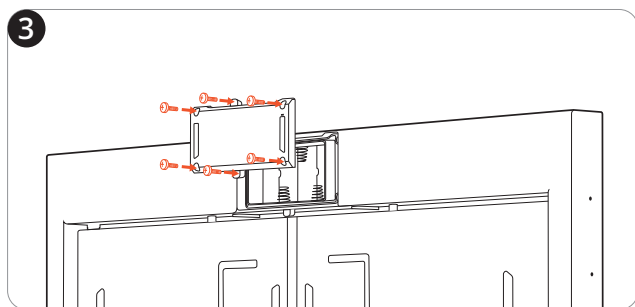
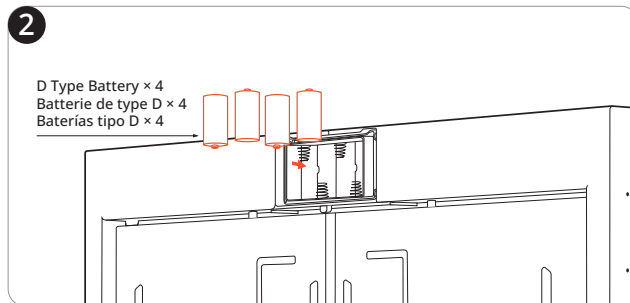
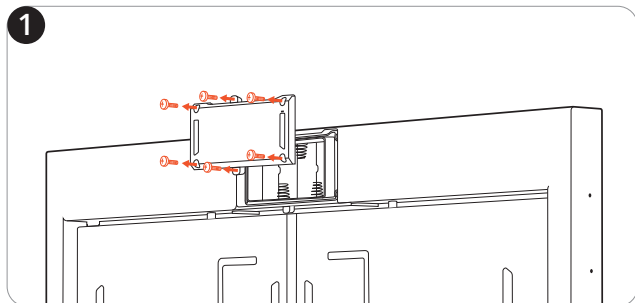

## 2.5 Install the magnet

Power off the mower, find a flat surface, turn the mower upside down with caution. Put the magnet into the magnet holder. Attach an adhesive sticker at the back of the magnet holder.

**NOTE:** To install it properly, wipe the areas where you need to install on the mower.

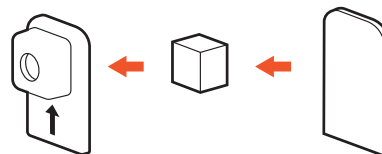

### For i1 Series and i2 AWD

1. Install it under the mower, behind the handle.
2. Make sure the arrow on the magnet holder points left.

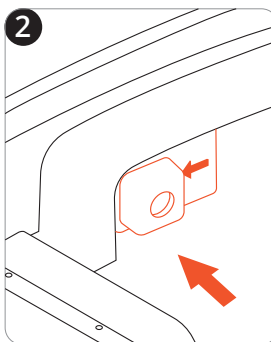
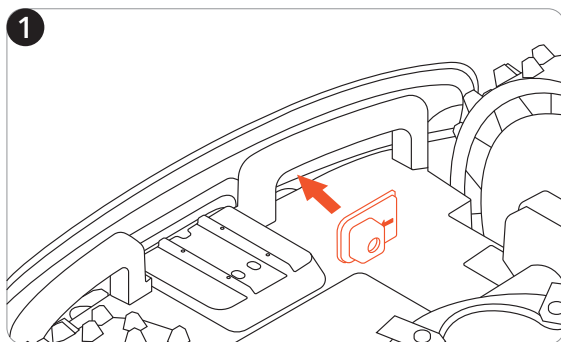

## For i2 LiDAR

1. Slide the magnet holder into the gap between the front edge of the mower and the battery slot.
2. Make sure the arrow on the magnet holder points down.

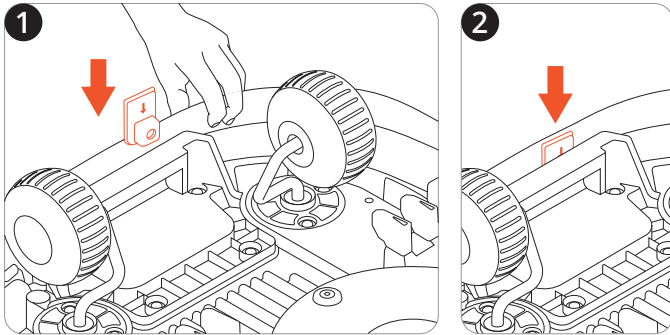

## For X3 Series

1. Slide the magnet holder under the mower, near the front edge of the mower.
2. Make sure the arrow on the magnet holder points down.

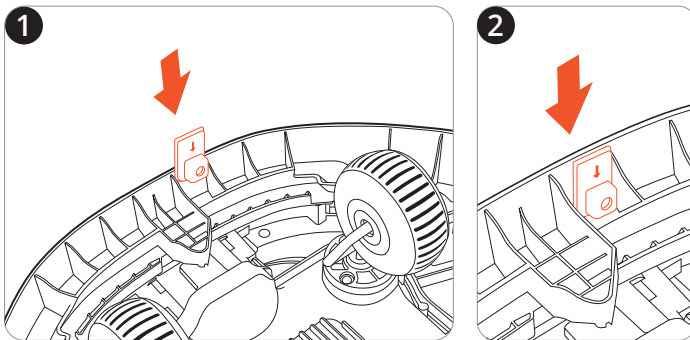

## For X4 Series

A magnet has already been installed inside the X4 mowers. No installation is needed.

## For H2 Series

1. Remove the 6 screws securing the board between the two caster wheels. Next, remove the board.
2. Put the magnet inside the cubic slot.
3. Install the board back and tighten the screws.

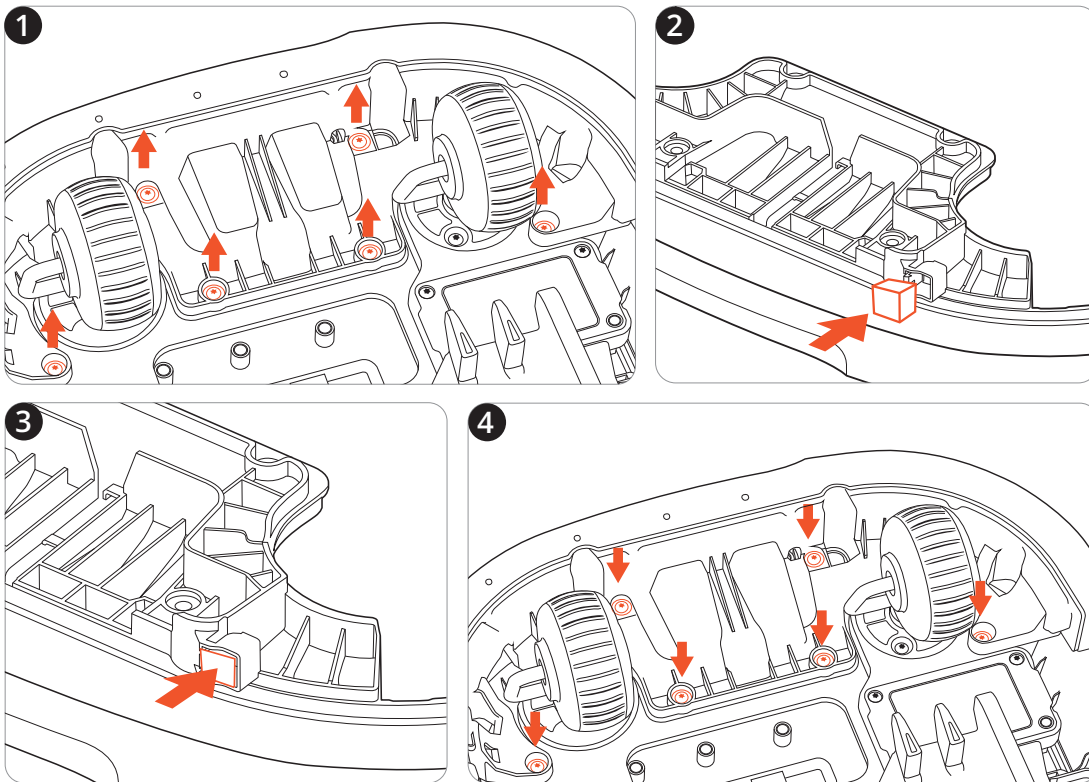

## 2.6 Create Channel to the MowGate

1. Go to Home > Settings > Map management > Edit map > Add more.
2. Tap on the MowGate icon.
3. Follow the instructions via the Navimow app to guide the mower to pass through the MowGate.  
Make sure you have created mowing zones on both sides of the MowGate.





## 3. Maintenance

### 3.1 Replace batteries

When the light on the MowGate shows yellow, it means the battery level is 50% or lower.

When the light on the MowGate shows red, replace the old Type D batteries.

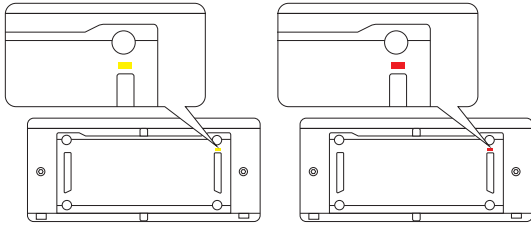

### 3.2 Clean the MowGate

Use a soft brush to brush away dirt.

Wipe off mud stains with a dampened towel.

Use a piece of dry cloth to wipe the MowGate dry.

### 3.3 Lubricate the frames

Lubricate the MowGate frames with the WD-40 gel lube or other similar lubricant.

**NAVIMOW**